

PROOF #	
DESIGNER: KAREN	DATE: 5/5/14
PROOFING: 1st - _____ 2nd - _____ 3rd - _____	
I have thoroughly reviewed this project and approve the following:	
<input type="checkbox"/> Send to print	<input type="checkbox"/> Do not print - corrections attached
BROKER _____	CLIENT _____
MANAGER _____	
LISTING NUMBER _____	
<p>NOTE: ALL signatures MUST be received before this box is removed. By initializing above you are authorizing use of this content in both print and electronic marketing.</p>	

NWC BUCKEYE ROAD & 94TH AVENUE

±12 ACRES AVAILABLE FOR SALE (1-2) ZONING

TOLLESON, ARIZONA

2415 EAST CAMELBACK ROAD | PHOENIX, ARIZONA 85016
 T 602.735.5555 | F 602.735.5655 | WWW.CBRE.COM/PHOENIX



±12 ACRES AVAILABLE FOR SALE

**NWC BUCKEYE ROAD & 94TH AVENUE
TOLLESON, AZ**

ELECTRICAL: APS

PARCEL SIZE: ±12 ACRES

ZONING: I-2

**SEWER: 15" SEWER LINE IN BUCKEYE RD;
6" SEWER LINE IN 94TH AVE**

**WATER: 8" WATER LINE IN BUCKEYE RD;
6" WATER LINE IN 94TH**

PARCEL: 101-06-427

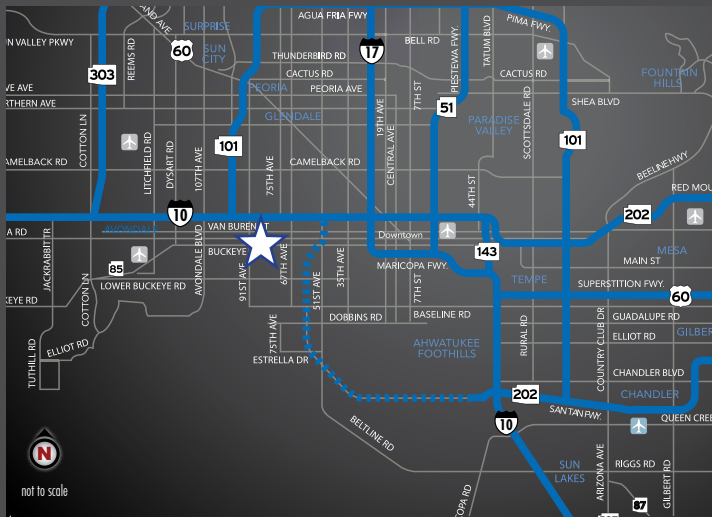

**FOR MORE
INFORMATION
PLEASE
CONTACT:**

JOHN WERSTLER
Senior Vice President
602.735.5504
john.werstler@cbre.com

COOPER FRATT
Associate
602.735.5037
cooper.fratt@cbre.com

CBRE

This property is located in a flood zone.

© 2014 CBRE, Inc. This information has been obtained from sources believed reliable. We have not verified it and make no guarantee, warranty or representation about it. Any projections, opinions, assumptions or estimates used are for example only and do not represent the current or future performance of the property. You and your advisors should conduct a careful, independent investigation of the property to determine to your satisfaction the suitability of the property for your needs. JW9603_05/2014